

HUDSON'S BAY CENTRE CONCOURSE LEVEL

2 Bloor Street East, Toronto, Ontario

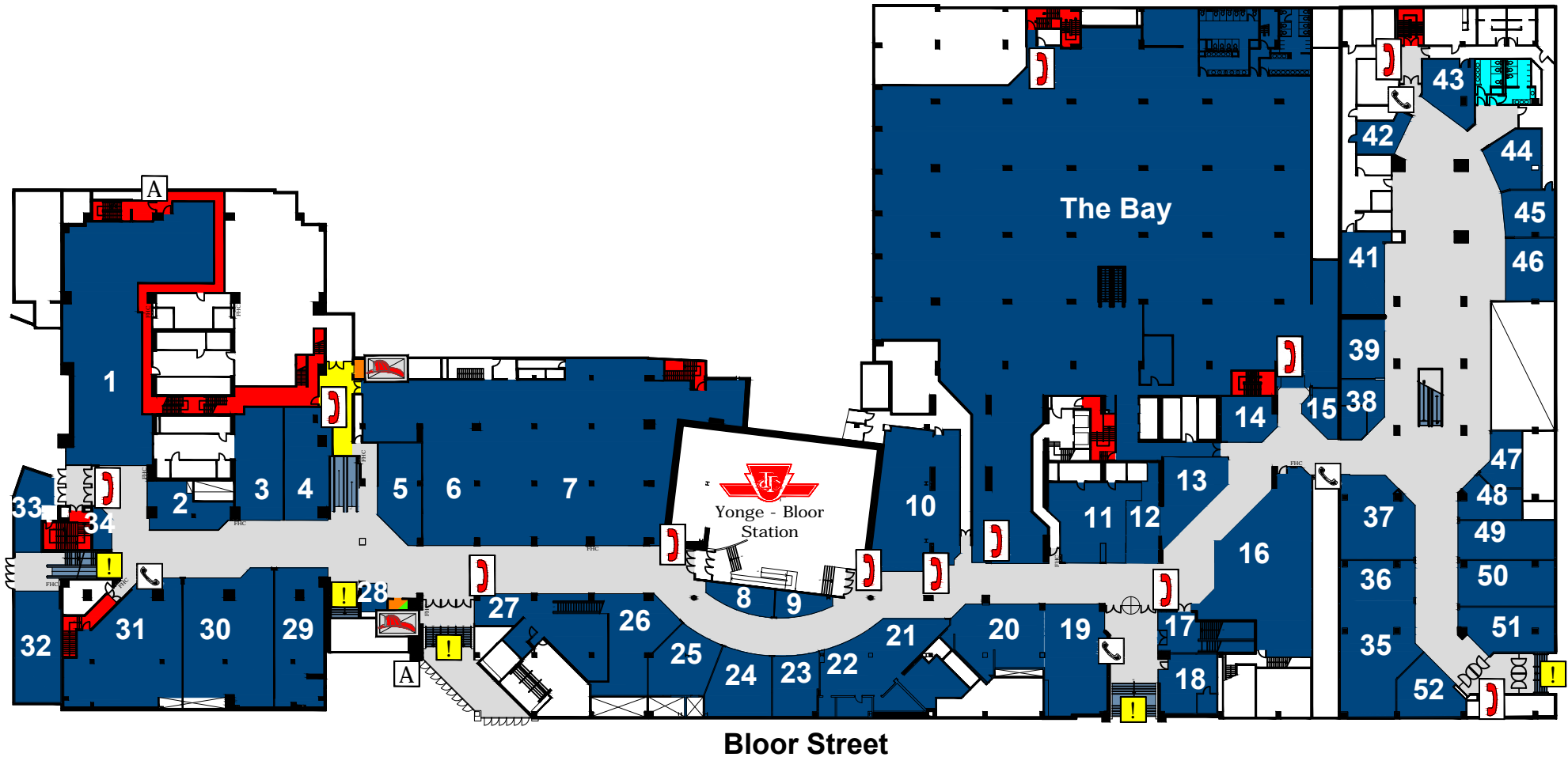

- | | | | |
|-----------------------------|---|----------------------------|--------------------------|
| Retail Units | Alternate Barrier-Free Route | Payphone | Fire Fighter's Telephone |
| Public Space | Emergency Exits (Stairs) | Automatic Doors | Fire Fighter's Elevator |
| Stairs/Escalators/Elevators | Fire-fighter Elevator / Barrier-Free emergency exit | Warning: Physical Barriers | |
| Barrier-Free Restrooms | Place of Refuge | | |

HUDSON'S BAY CENTRE CONCOURSE LEVEL

2 Bloor Street East, Toronto, Ontario

Retail Directory

- | | |
|------------------------------|-------------------------------|
| 1. Concepts Day Spa Salon | 27. MAC Cosmetics |
| 2. Purdys Chocolatier | 28. International News |
| 3. Stepss | 29. Starbucks |
| 4. Bentley | 30. Ardene |
| 5. Shoppers Drugmart | 31. The Source |
| 6. Shoppers Drugmart | 32. The Grind |
| 7. Shoppers Drugmart | 33. Moneysworth & Best |
| 8. Stylessence Jewellery | 34. Enterprise - Coming Soon |
| 9. Andrew's Ties | 35. Midtown Dental |
| 10. LCBO | 36. Midtown Dental |
| 11. De Ritz Leather Boutique | 37. La Prep |
| 12. Print Pix | 38. Extreme Pita |
| 13. Vacant | 39. Vacant |
| 14. Great American Backrub | 41. Mr. Souvlaki |
| 15. Treats | 42. Subway |
| 16. RBC Insurance | 43. Tandori |
| 17. Vacant | 44. Thai Express |
| 18. Alterations + | 45. A&W/Country Style Express |
| 19. Vacant | 46. Manchu WOK |
| 20. Vacant | 47. Booster Juice |
| 21. Vacant | 48. International News |
| 22. Vacant | 49. Bagel Stop |
| 23. Wireless Wave | 50. Bloorview Postal Services |
| 24. Meena's Linens | 51. Hertz |
| 25. Nutrition House | 52. Avis |
| 26. Bay Optical | |

In Case of Emergency

In the event of an emergency please remain calm and proceed to the nearest EXIT stair indicated in solid **RED** on the plan.



For those unable to exit via the stairs

Notify Emergency Personnel of your location using one of the many Fire Fighter's telephones located on the floor.

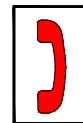

Proceed to the nearest Area of Refuge or safe area near an elevator lobby or EXIT stair.



Await assistance by emergency personnel.